

Kingsland Close, Stone, ST15 8FF

£850 Per Month

Council Tax Band:



A very attractive semi detached house on the much sought after Aston Lodge Park, allocated parking and a single garage. This property is well located for B5027, A51, A34 and is in catchment for St Michael's C of E primary school which is an Ofsted rated good school.

In brief the accommodation comprises of:- entrance hall, lounge/diner, kitchen/breakfast room with cooker, hob, extractor, combination boiler and door to rear garden. Two bedrooms both with built in wardrobes, family bathroom with electric shower over bath. Small low maintenance gardens to the front and rear with side access gates and views over fields.

Minimum 12 month tenancy



Open House Staffordshire

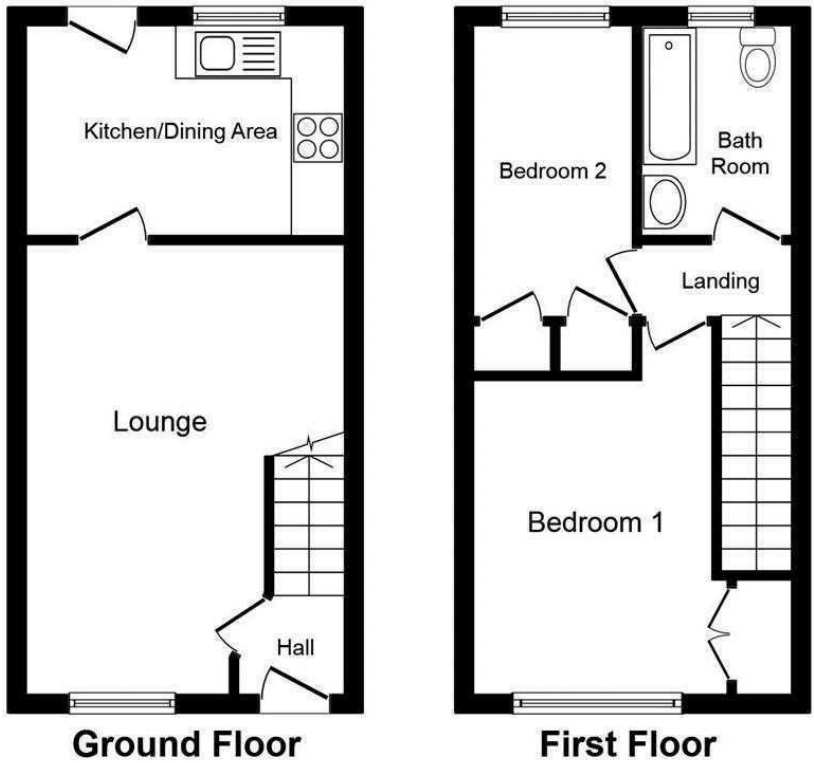

Total Floor Area 54.0 sq. m. (581 sq. ft.)

This plan is for illustration purposes only and may not be representative of the property. Plan not to scale.

Powered by audioagent.com

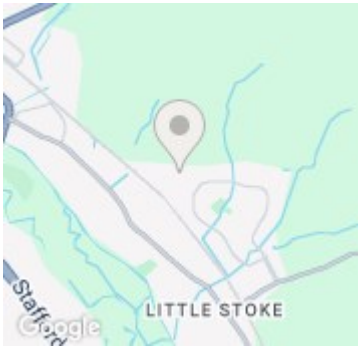

Energy Efficiency Rating		
	Current	Potential
Very energy efficient - lower running costs		
(92 plus) A	81	81
(81-91) B		
(69-80) C		
(55-68) D		
(39-54) E		
(21-38) F		
(1-20) G		
Not energy efficient - higher running costs		
England & Wales		EU Directive 2002/91/EC 